

Working Parameters and Specifications

Maximum Inlet Pressure:	10 Bar
Operating Pressure:	1.0 - 6 Bar
Adjustable Flow Rate:	0.5 - 6 lpm
Operating Sensitivity:	15%
Maximum Temperature:	30°C
Connection Size:	1/2" FBSP
Suitable Media:	Water

Pressure Drop Required

Inlet Pressure	Volume	Pressure Drop
1.0 bar	100 - 750ml	0.45 Bar
2.0 bar	200 - 1300ml	0.5 Bar
3.0 bar	250 - 1600ml	0.6 Bar
4.0 bar	250 - 1800ml	0.7 Bar
5.0 bar	250 - 1400ml	0.85 Bar

Dimensions

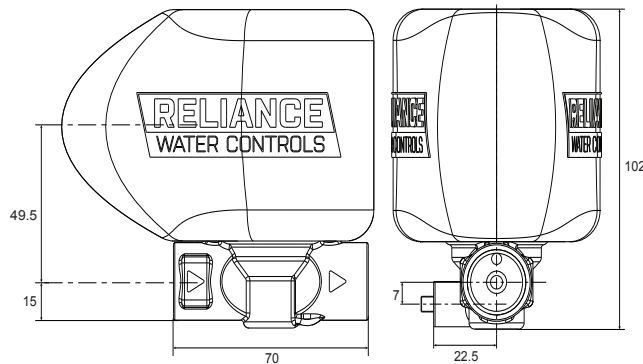

All dimensions are in mm



**Reliance Worldwide Corporation
(UK) Ltd
Worcester Road,
Evesham,
Worcester,
WR11 4RA,
UK**

**Tel: +44 (0)1386 712 400
Fax: +44 (0)1895 712 401**

www.rwc.co.uk

Installation and Maintenance
Instructions

RELIANCE

The Governor Pressure Operated Urinal Flush Valve



Reliance Worldwide Corporation (UK) Ltd reserves the right to make changes to the product which may affect the accuracy of information contained in this leaflet.

ZINS100001_001_07-17

Reliance Worldwide Corporation (UK) Ltd.

Reliance Worldwide Corporation (UK) Ltd are part of the Australian based group of companies collectively known as Reliance Worldwide Corporation, with the UK brand known as Reliance Water Controls.

Reliance Worldwide Corporation (UK) Ltd is a specialist in the design, distribution and technical support for temperature and flow controls.

With group offices and manufacturing plants throughout the world RWC offers a wealth of knowledge and expertise which is reflected throughout our products. Being part of many specialised trade associations and having our own UKAS accredited laboratory, makes us at the forefront of any new regulations or changes which impact the industry, and allows for continuous product development and innovation, within our specialised product area.

General Function

The Pressure Operated Urinal Flush valve (Governor) is installed on the supply pipe to a urinal cistern. The valve is activated by short-term pressure drops created by use of taps or WCs on the same supply. The valve is normally closed; when it is activated it opens and water passes to the urinal cistern until the pressures on both sides of the valve are equalised. When the cistern is full, the auto-siphon will flush.

Installation

Please ensure you do not put the valve under any undue stress in the pipework.

Install the Governor valve into your pipework, it can be installed in any orientation as long as the flow is in the correct direction, this is indicated by the arrow on the base of the valve. Please ensure the installation position allows for access to the flow adjustment mechanism as this needs to be accessible.

Please see overleaf for typical installation examples.

Typical Installation

Below shows two typical types of installs suitable for the Governor valve.

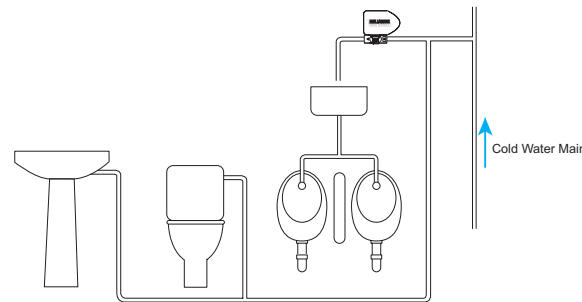
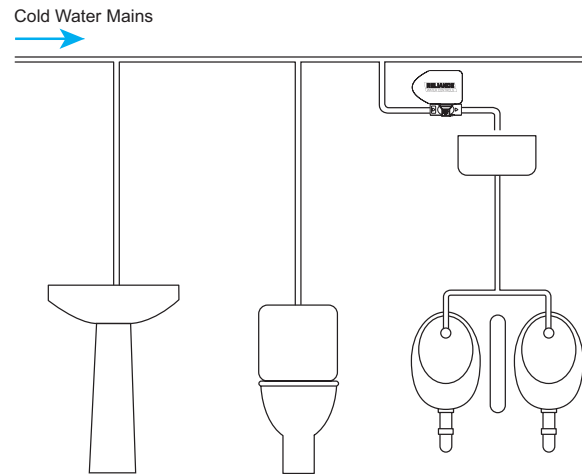

Commissioning

Once installed the flushing volume needs to be set.

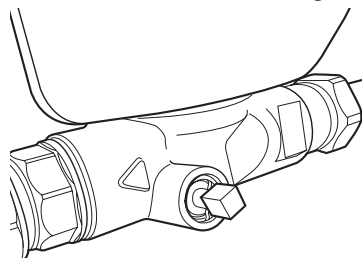

The flow adjustment screw is located on one side of the brass body.

Using the supplied tool or an adjustable spanner, turn the screw anti-clockwise to open the water pathway or clockwise to close it.

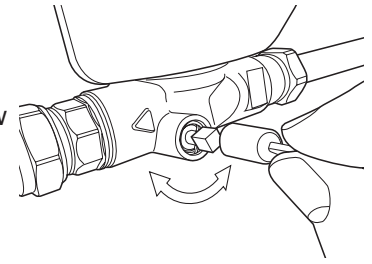

The graph below gives an indication of the water volume discharged with the adjustment screw open 1.5 rotations (halfway open).

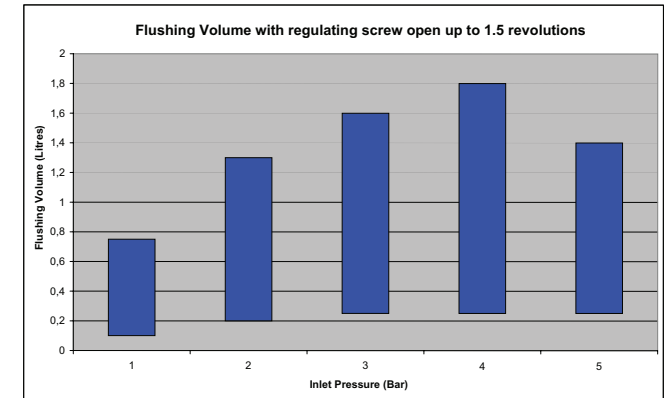

For example; with an inlet pressure of 2 Bar, depending on the pressure drop, the valve will allow between 0.2-1.2 litres of water to discharge into the urinal cistern.

Note: The length of time the valve takes to close is not adjustable and is set to 12-15 seconds.

Once set, the valve now has to be vented. Firstly locate the hexagon screw on top of the valve, using a 8mm socket turn it clockwise to open and anti-clockwise to close. Repeat this several times.

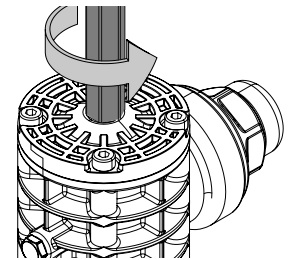

After venting tighten the screw hand-tight.

For final commissioning it is recommended that the valve is vented during both the first operation and static conditions once the pressure has equalised.