



SHARKBITE® 45° ELBOWS

SB0515	45° Elbow, 15mm, Pack Quantity: 10
SB0522	45° Elbow, 22mm, Pack Quantity: 5
SB0528	45° Elbow, 28mm, Pack Quantity: 5
SB0535E	45° Elbow, 35mm, Pack Quantity: 1
SB0542E	45° Elbow, 42mm, Pack Quantity: 1
SB0554E	45° Elbow, 54mm, Pack Quantity: 1

OVERVIEW

The SharkBite range of slimline metal push-fit plumbing fittings provide a fast, secure and heat-free pipework connection which is suitable for all domestic and commercial applications. The fittings are compatible with all types of commonly used metal and plastic pipe: copper, PEX, carbon steel and polybutylene. They can be easily disconnected and are immediately re-usable. This selection of elbows connects pipe at a 45 degree angle with SharkBite's quick and simple cut – push – done operation.



WATER CONTROLS FOR A MODERN WORLD

RELIANCE

TEMPERATURE
CONTROL

FLOW
CONTROL

HEATING SYSTEM
COMPONENTS

WASHROOM
SYSTEMS

HEATING & COOLING
DISTRIBUTION SYSTEMS

PLUMBING
SYSTEMS

SHARKBITE® 45° ELBOWS

WORKING PRESSURES AND TEMPERATURES

Size	Pipe	Pressure/Temperature			
		12 Bar / -20°C	12 Bar / 20°C	6 Bar / 65°C	6 Bar / 95°C
10mm	PEX or PB	12 Bar / -20°C	12 Bar / 20°C	6 Bar / 65°C	6 Bar / 95°C
	Copper	16 Bar / -24°C	16 Bar / 30°C	10 Bar / 65°C	6 Bar / 95°C
15mm	PEX or PB	12 Bar / -20°C	12 Bar / 20°C	6 Bar / 65°C	6 Bar / 95°C
	Copper/Carbon Steel	20 Bar / -24°C	20 Bar / 30°C	16 Bar / 65°C	10 Bar / 120°C
22mm	PEX or PB	12 Bar / -20°C	12 Bar / 20°C	6 Bar / 65°C	6 Bar / 95°C
	Copper/Carbon Steel	20 Bar / -24°C	20 Bar / 30°C	16 Bar / 65°C	10 Bar / 120°C
28mm	PEX or PB	12 Bar / -20°C	12 Bar / 20°C	6 Bar / 65°C	6 Bar / 95°C
	Copper/Carbon Steel	20 Bar / -24°C	20 Bar / 30°C	16 Bar / 65°C	10 Bar / 120°C
35mm	Copper/PEX/Carbon Steel	16 Bar / -24°C	16 Bar / 30°C	10 Bar / 65°C	6 Bar / 95°C
42mm	Copper/PEX/Carbon Steel	16 Bar / -24°C	16 Bar / 30°C	10 Bar / 65°C	6 Bar / 95°C
54mm	Copper/PEX/Carbon Steel	16 Bar / -24°C	16 Bar / 30°C	10 Bar / 65°C	6 Bar / 95°C

FEATURES AND BENEFITS

- Quick and easy to install in both wet or dry conditions
- Heat/flux free installation, for when flame jointing not permitted
- No expensive tools required
- Quick and easy to demount
- Instantly reusable
- Versatile: same fitting can connect all types of commonly used metal and plastic pipe, in any combination
- Slim, compact design and fully rotatable: ideal for use in confined spaces or on exposed pipework
- Electrically continuous (when used with copper or carbon steel pipe)

STANDARDS AND APPROVALS

- WRAS Approved

PIPE COMPATABILITY

COPPER: Copper pipe manufactured in accordance with BS EN 1057 in sizes 10mm to 54mm. If 10mm annealed Copper pipe is being used, it must be re-calibrated in accordance with Table 4 R250 tolerances in the above standard and a Copper liner installed into the pipe prior to assembly.

PEX: SharkBite cross linked Polyethylene (PEX) manufactured to BS 7291: Part 3 in sizes 10mm to 54mm utilising the specific manufacturer's pipe liner.

POLYBUTYLENE: Polybutylene (PB) manufactured to BS 7291: Part 2 when utilising the specific manufacturer's liner.

CARBON PIPE: Carbon Steel pipe manufactured to EN 10305-2

ELECTRICAL CONTINUITY: SharkBite fittings are TRaC certified to provide electrical continuity when used with Copper or Carbon Steel pipe with the exception of 10mm fittings.

MATERIALS

Body:	DZR Brass
O Ring:	Ethylene Polypropylene Diene Monomer (EPDM)
15, 22 & 28mm Cartridge:	304 Stainless Steel
35, 42 & 54mm Cartridge:	Polyphenylsulfone (PPSU)
Grab Ring:	316 Stainless Steel
Disconnecting Ring:	Acetal Copolymer
Alignment Ring:	Nylon 6

GUARANTEE

All SharkBite fittings are guaranteed against defects in materials or manufacturing for a period of 25 years from the date of purchase.

ACCESSORIES

SB2910:	10mm Depth Marker/Disconnecting Clip
SB2915:	15mm Depth Marker/Disconnecting Clip
SB2922:	22mm Depth Marker/Disconnecting Clip
SB2928:	28mm Depth Marker/Disconnecting Clip
SB2910-28:	10mm–28mm Depth Marker/Disconnecting Clip Set 10mm-28mm
SB3010:	10mm Disconnecting Tongs
SB3015:	15mm Disconnecting Tongs
SB3022:	22mm Disconnecting Tongs
SB3028:	28mm Disconnecting Tongs
SB2935:	35mm Disconnecting Clip
SB2942:	42mm Disconnecting Clip
SB2954:	54mm Disconnecting Clip
SB2935-54:	35-54mm Depth Marker

DIMENSIONS

All dimensions in mm unless otherwise stated.

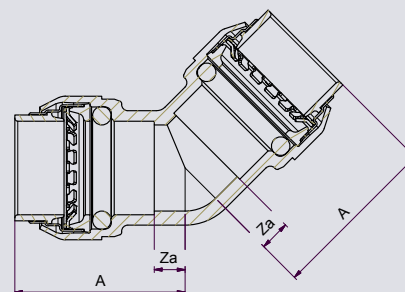

Size	Code	A	Za
15mm	SB0515	28mm	5mm
22mm	SB0522	43mm	10mm
28mm	SB0528	40mm	8mm
35mm	SB0535E	64mm	9mm
42mm	SB0542E	71mm	10mm
54mm	SB0554E	78mm	13mm