

RW153HC Thermostatic Mixer Shower

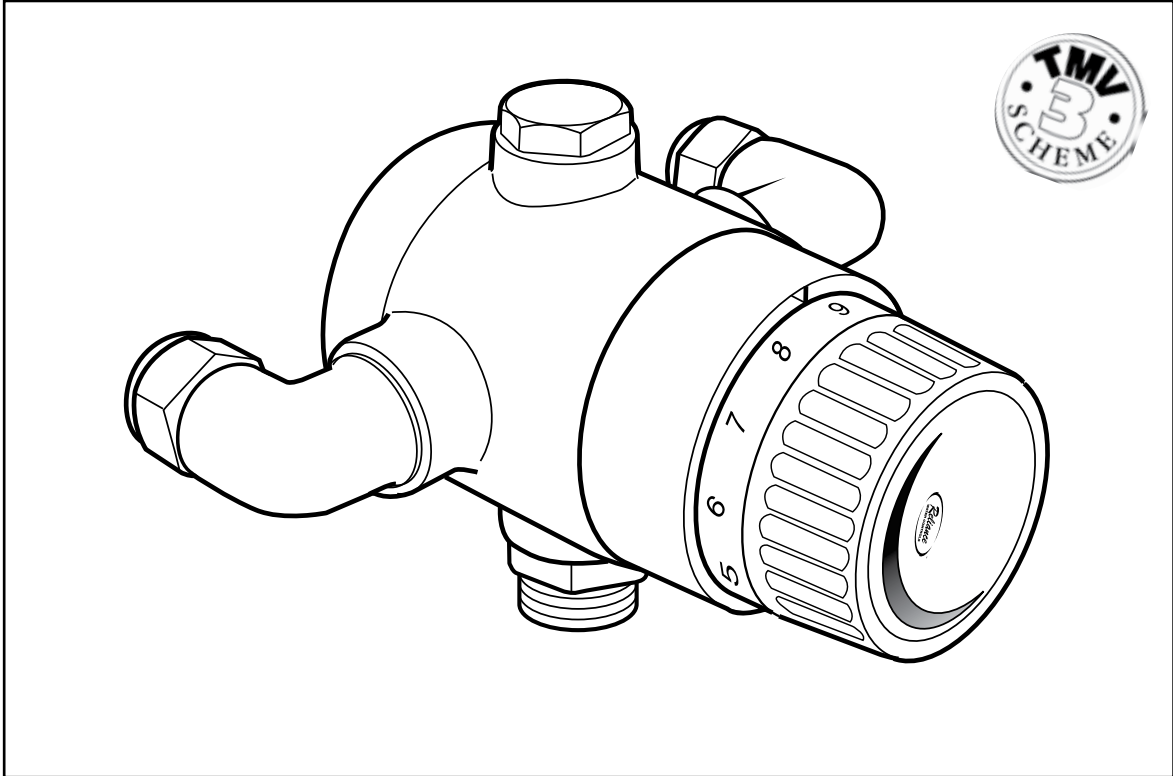

Single point showers designed for single outlet use.

Product Features and Benefits

- Works on all domestic heating systems, at pressures from 0.1 to 5.0 bar.
- Supplied complete with **flow restrictors**.
- **Up to 8 litres per minute at 1 metre head.**
- **Rapid shut off on hot or cold supply failure.**
- **Easy to install** with 360° swivel elbows.
- **Simple to operate** with **single control** for both **flow and temperature.**
- **Brass body and internals.**
- **Fully serviceable.**
- Full range of fitting options available.

- ✓ Exceeds the requirements of NHS Model Engineering Specification D08 for thermostatic mixing valves in Health Care premises (TMV3).

RW153HC Thermostatic Mixer Shower

Description

The RW153HC single point shower control is designed for single outlet use in conjunction with the Reliance shower kit range. The showers can be supplied suitable for exposed or concealed mounting and with a variety of optional control knob styles. Exposed parts are chrome and white unless otherwise stated. Plain white finish can be supplied to special order.

Product Range

SHOW 153 001

White knob, chrome body, exposed fittings

SHOW 153 002

White knob, chrome body, concealed fittings

SHOW 153 003

Chrome knob, chrome body, exposed fittings

SHOW 153 004

Lever version, chrome body, exposed fittings

Performance

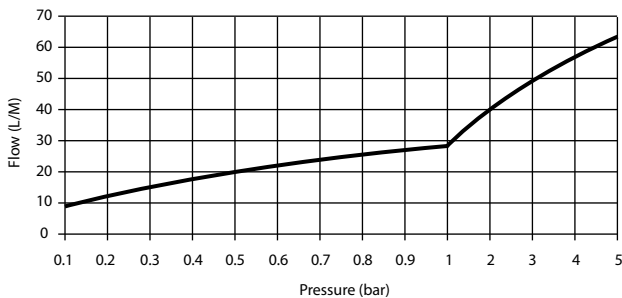

Materials

Body:	Cast gunmetal
Internal components:	DZR brass
Seals:	Nitrile elastomer
Spring:	Stainless steel
Piston:	DZR brass, PTFE coated
Fittings:	DZR brass
Strainers:	Plastic

Standards

The RW153HC is manufactured from WRc approved materials and is UK WFBS listed.

WRc approval No: 9709055.

It is designed to comply with NHS Model Engineering Specification D08 Thermostatic Mixing Valves (Healthcare premises).

TMV3 approved Certificate No:ETC/42/0498.

Dimensions

Concealed version with lever

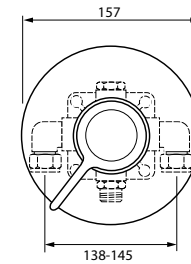

Exposed version with knob

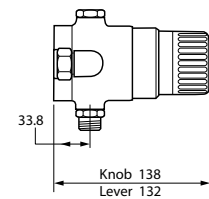
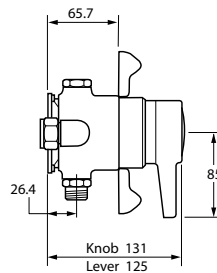
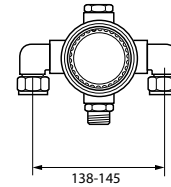

Specifications

Factory set temperature: 43°C

Temperature setting range: 30°- 50°C

Temperature, hot supply: 80°C max.*

*The sensitive wax capsule will shut down the operation of the valve if either the hot or cold supply fails, provided a minimum differential of 10°C exists between the mixed water temperature and the remaining supply.

Temperature, cold supply: 5° - 25°C

Temperature stability: ±2°C

Static pressure: 10 bar max.

Operating pressure: 0.1 - 5.0 bar

Max. pressure loss ratio: 10:1

Inlets: 15mm compression swivel elbows

Outlets: 1/2" BSP

Weight: 2.3 Kg

How to Specify

Thermostatic, concealed or exposed sequential shower mixer to TMV3, with wax element capsule, supplied with flow regulation accessories and suitable for all domestic heating systems (select appropriate range code).

Guarantee

All Reliance products undergo strict performance tests prior to despatch, and are guaranteed against faulty materials and workmanship for one year from date of purchase. This is in addition to any statutory rights.



Reliance Water Controls

Worcester Road, Evesham, Worcestershire, WR11 4RA, UK
Tel: +44 (0)1386 712400 Fax: +44 (0)1386 712401 www.rwc.co.uk

