

## Heatguard® CS3 Shower Valve

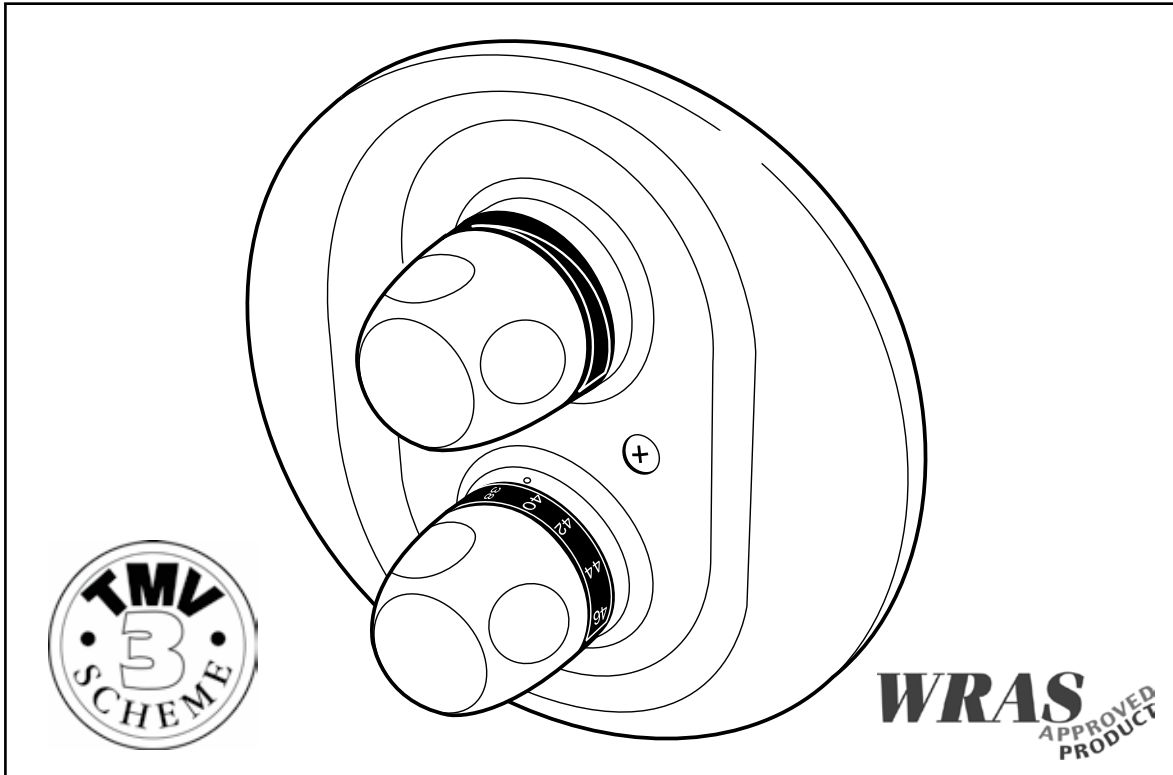

Contemporary style shower with dual control.

### Product Features and Benefits

- **TMV3 approved** shower valve for **safe use** in installations where users are deemed to be at risk.
- **Single piece** thermostatic cartridge with integral sleeve strainers **simplifying** maintenance thus **reducing downtime**.
- **Stable temperature management** and **quick reaction to changing supply conditions**.
- Wax element thermostatic technology **reduces risk of scalding**.
- **Long lasting ceramic disc** flow control for **easy operation**.
- Available with either contemporary style knobs or lever handles.
- Comes complete with integral isolators and check valves which are accessible from the front.

- ✓ WRAS Approved.
- ✓ Buildcert approved.
- ✓ NHS Estates TMV3 Approved.

# Heatguard® CS3 Shower Valve

## Description

The Heatguard® CS3 is a TMV3 shower valve of contemporary style with unique, easy to use separate controls which allows more accurate temperature selection. The specially designed large internal flow paths give a greater flow than normally experienced.

## Product Range

THRM 503 001: Heatguard® CS3 Concealed TMV3 shower  
 THRM 503 010: Heatguard® CS3 Concealed TMV3 shower with lever handles

## Performance

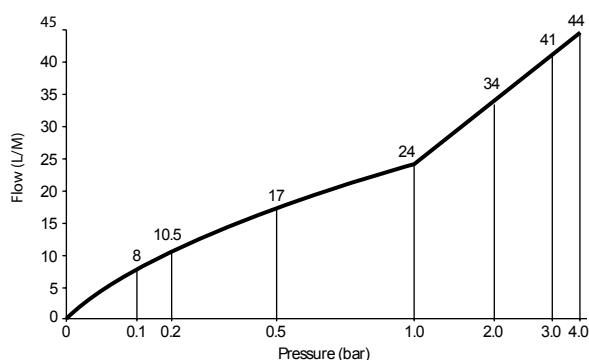

## Materials

Body: Cast brass  
 Inlet strainers: Stainless Steel  
 Cartridge: Brass CW 614 N  
 Seals: NBR  
 Piston coating: PTFE  
 Protective coatings: Chrome

## Specifications

Minimum flow pressure: 0.1 bar  
 Recommended flow pressure range: 0.2 - 2.0 bar  
 Test pressure static: 10.0 bar  
 Working pressure dynamic: 0.1 - 5.0 bar  
 Maximum pressure loss ratio: 5:1  
 Maximum hot water temperature @ inlet: 85°C  
 Recommended stored temperature: 60°C  
 Minimum hot/blend temperature difference: 10°C  
 Factory setting @ 2 bar equal pressures: 38°C ± 1°C  
 Hot water connection: Left  
 Cold water connection: Right  
 Inlet connections: 3/4"

## Dimensions

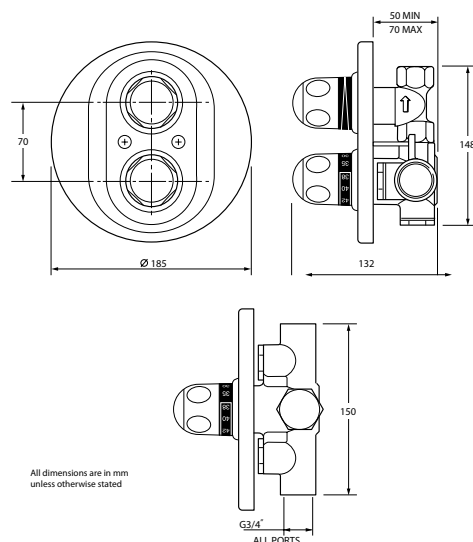

## Standards

Buildcert approval number BC/068/10/03

### TMV3 approval designations

HP-SE High pressure shower economy  
 maximum temperature 41°C  
 LP-SE Low pressure shower economy  
 maximum temperature 41°C

## Approvals

WRAS approval number 0304099

## How to Specify

Contemporary styled TMV3 approved thermostatic mixing shower valve with separate flow and temperature control handles and a choice of either a top or bottom outlet port. (Include correct product range code).

## Guarantee

All Reliance® products undergo strict performance tests prior to despatch, and are guaranteed against faulty materials and workmanship for one year from date of purchase. This is in addition to any statutory rights.



**Reliance Water Controls®**

Worcester Road, Evesham, Worcestershire, WR11 4RA, UK  
 Tel: +44 (0)1386 712400 Fax: +44 (0)1386 712401 www.rwc.co.uk

