

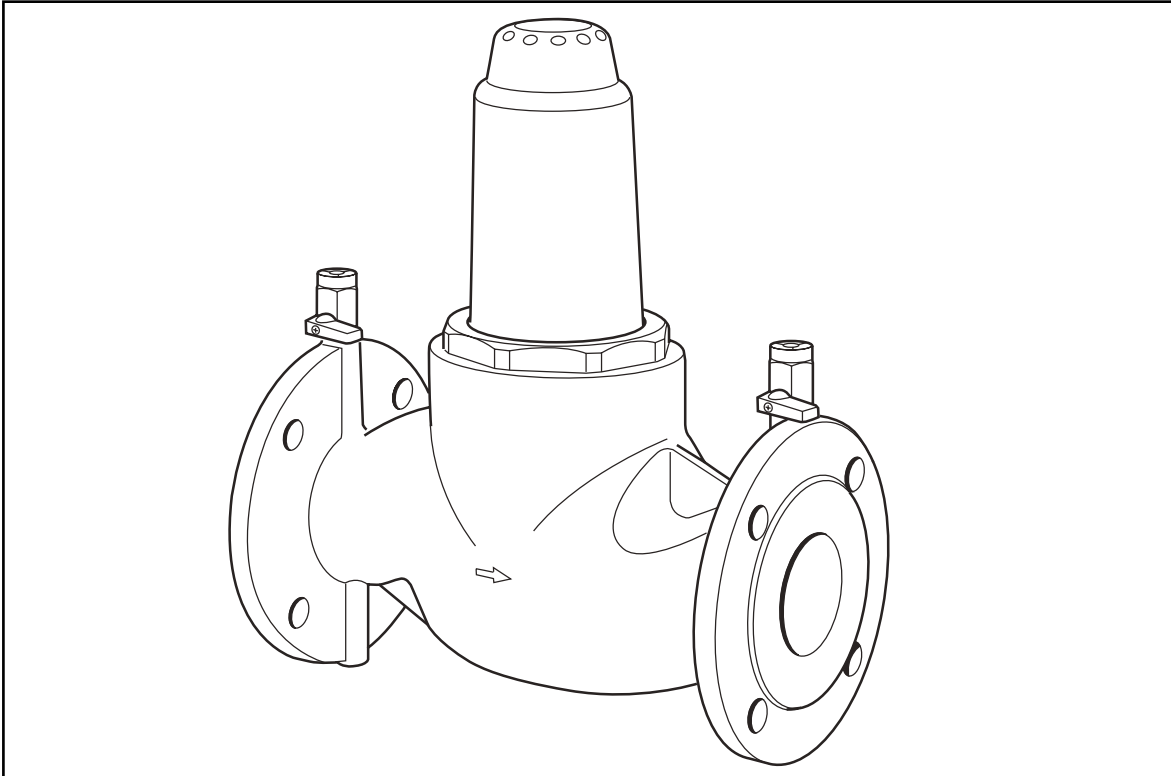

Product Specification Sheet

6247 Pressure Reducing Valve



High flow rate pressure reducing valve with accurate pressure control suitable for industrial and commercial applications.

Product Features and Benefits

- **Single piece cartridge system allows for easy servicing or replacement minimising down-time.**
- **Accurate pressure control.**
- Suitable for **inlet pressures up to 16 bar with adjustable outlet pressures of from 1.5 - 6.0 bar giving flexibility on system design.**
- Can be **mounted in any position for ease of installation.**
- **Unique moulded comb ensures quiet operation (20db - class 1 acoustics) ensuring that noise created by restrictions are eliminated.**
- Suitable for system temperatures of up to **60°C (up to one hour maximum) enabling use with either hot or cold water.**

✓ DVGW approved.

6247 Pressure Reducing Valve

Description

A high quality pressure reducing valve with balanced single seated in-line one piece pressure reducing cartridge, for flange connection in accordance with DIN 86021. Can be mounted in any position within the installation and will give substantial flow rates with accurate pressure control. The dial-up pressure setting feature is secured with a tamper proof system once the desired pressures have been set. Unique moulded comb ensures quiet operation - 20db class 1 acoustics. Single piece cartridges with integral strainers ensure cartridge protection and long life, easy maintenance with minimum downtime.

Product Range

PRED 624 001: DN 65 Adjustable PRV 1.5 bar - 6.0 bar
 PRED 624 002: DN80 Adjustable PRV 1.5 bar - 6.0 bar
 PRED 624 003: DN100 Adjustable PRV 1.5 bar - 6.0 bar

Flow characteristics

DN65

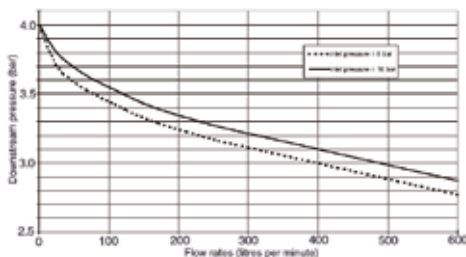

DN80

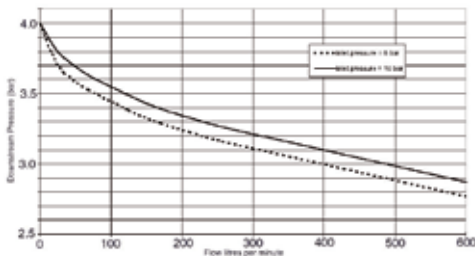

DN100

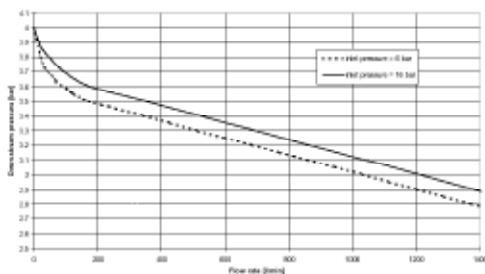

Dimensions

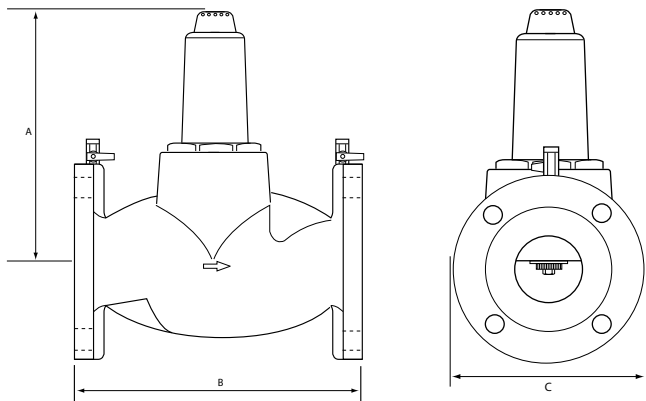

Part Code	A (mm)	B (mm)	C (mm)
PRED 624 001	283	290	185
PRED 624 002	283	310	200
PRED 624 003	283	350	220

Materials

Body: Bronze
 Spring cap: High grade glass reinforced plastic
 Seals: Heat and age-proof rubber elastic
 Diaphragm: Heat and age-proof rubber elastic reinforced with polyamide fabric inlay
 Strainers: Corrosion protected steel mesh (0.25mm)
 Spring: Corrosion protected spring steel

Approvals & Standards

DVGW Approved
 BS EN 1567

Specifications

Maximum inlet pressure: 16 bar
 Outlet pressure range: 1.5 - 6.0 bar
 Maximum operating temperature: 45°C
 Factory setting: 4 bar
 Media: Water / compressed air
 Flange: PN16

How to Specify

A in-line cartridge pressure reducing valve with full flow coaxial strainers, single piece cartridges with lockable dial-up facility on cartridges. Flanged to PN16. (Include correct product range code).

Guarantee

All Reliance products undergo strict performance tests prior to despatch, and are guaranteed against faulty materials and workmanship for one year from date of purchase. This is in addition to any statutory rights.



Reliance Water Controls®
 Worcester Road, Evesham, Worcestershire, WR11 4RA, UK
 Tel: +44 (0)1386 712400 Fax: +44 (0)1386 712401 www.rwc.co.uk

