

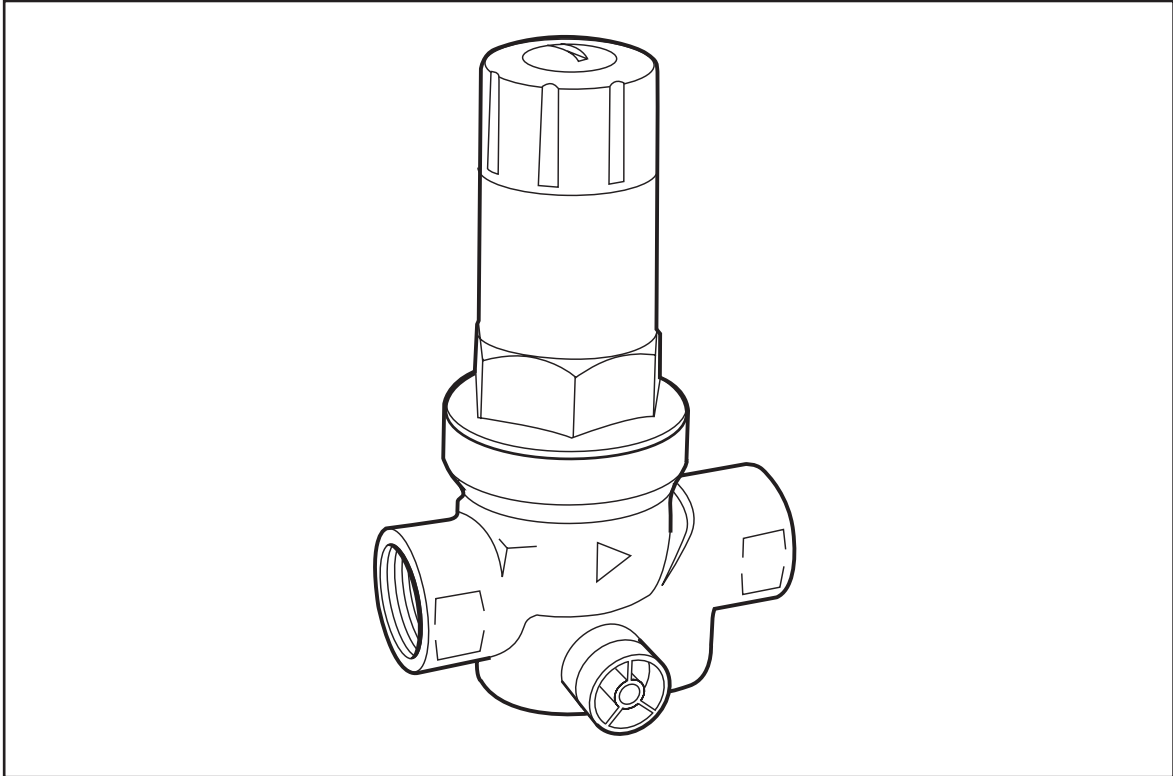

312 Series Pressure Reducing Valves



A pressure reducing valve for domestic applications.

Product Features and Benefits

- Superior quality pressure reducing valves.
- 1/2" to 1" models to regulate down stream pressure to set maximum.
- Adjustable outlet pressure, from 0.5 to 5.0 bar.
- High flow rate design.
- Multi media application (water, light oil, etc.)
- Pressure gauge test point for downstream reading.
- Fully serviceable strainer.
- Cartridge construction for ease of service and replacement.

✓ WRAS approved.

312 Series Pressure Reducing Valves

Description

A range of high quality pressure reducing valves, suitable for various applications at temperatures up to 40°C (60°C for 1 hour max.)

The valves are designed for low pressure drop, so minimising noise levels.

All models feature cartridge construction, fully serviceable strainer and female BSP connections for ease of installation and maintenance and are suitable for use with warm water, fuel oil, compressed air, neutral gases and neutral non-sticking liquids.

Product Range

PRED 310 100	1/2" 312 Adjustable PRV
PRED 310 400	3/4" 312 Adjustable PRV
PRED 300 003	1" 312 Adjustable PRV

Flow Characteristics

The graph below shows the flow from a valve set at 4.0bar outlet pressure with zero flow. As outlets are opened downstream, the pressure decreases and the flow increases accordingly.

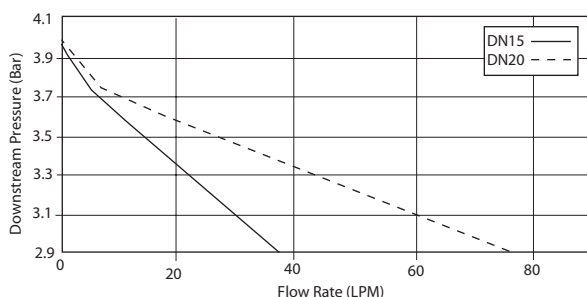

Materials

Body:	Stamped DZR brass (1/2") Cast gunmetal (3/4" & 1")
Internal components:	DZR brass
Seals:	NBR elastomer
Spring:	Zinc plated spring steel
Strainer:	Stainless steel
Diaphragm:	NBR elastomer nylon mesh
Cover:	Glass filled nylon polymer

Standards

EN 1567

Approvals

WRAS Certificate Nos.: 1/2" 9602022, 3/4" 9602021, 1" 9602020

Dimensions

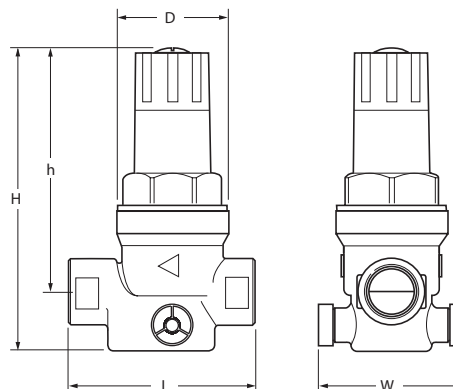

ØA	L	D	H	h	W
1/2"	70	38	109	95.5	64
3/4"	90	54	144	115.5	70
1"	100	63	129	98	74

All dimensions are in mm unless stated

Specifications

Test pressure:	25 bar (body only)
Working pressure:	16 bar max.
Adjustable set pressure range:	0.5 - 5.0 bar (1.5 - 6 bar for 1")
Pressure reduction ratio:	10:1 max.
Working temperature:	40°C (60°C max. for 1 hour) (1" model = 40°C max.)

How to Specify

WRAS listed, female threaded pressure reducing valve with full flow strainer and all working components contained in a cartridge form, with two downstream test points, one either side (select appropriate range code).

Guarantee

All Reliance® products undergo strict performance tests prior to despatch, and are guaranteed against faulty materials and workmanship for one year from date of purchase. This is in addition to any statutory rights.



Reliance Water Controls®
Worcester Road, Evesham, Worcestershire, WR11 4RA, UK
Tel: +44 (0)1386 712400 Fax: +44 (0)1386 712401 www.rwc.co.uk

