

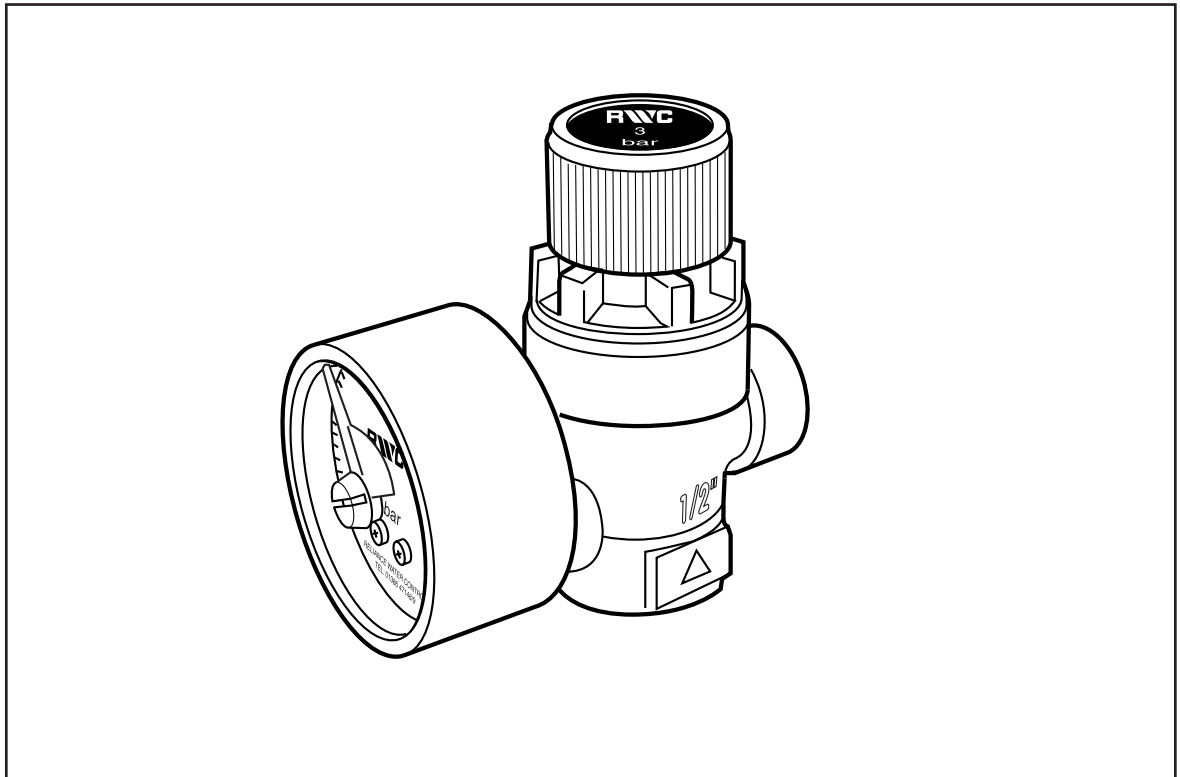

Product Specification Sheet

Pressure Relief Valve with Gauge



A pressure relief valve to protect sealed heating systems from overpressure.

Product Features and Benefits

- **High capacity** gives **overpressure protection** for heating systems.
- **Diaphragm design** gives **improved resistance to scaling**.
- **Cartridge design** gives **ease of service and replacement** without the need to re-set the opening pressure.
- **High lift design** for **increased discharge capacity**.
- Supplied **complete with pressure gauge** so that the system can be monitored easily.

Pressure Relief Valve with Gauge

Description

Made from hot pressed brass, the Pressure Relief Valve is predominantly used to protect closed-circuit water heating systems from overpressure. It has a separate seal seating from the diaphragm and a high grade glass fibre reinforced plastic twist cap. Supplied with 1/2" female connections and integral pressure gauge for system monitoring, it is set at 3.0 bar opening pressure which is indicated on the twist cap cover.

Product Range

PREL 103 003: 1/2"FBSP x 1/2"FBSP
Relief Valve with Gauge - 3 Bar Pressure

N.B.

Other pressure settings in the range of 1.0 bar - 5.0 bar are available by contacting the Reliance Sales Department.

Materials

Body: Hot pressed DZR brass
Diaphragm: EPDM Elastomer
Seal: EPDM Elastomer
Spring: Spring steel wire - corrosion protected
Internals: OT58 brass
Twist cap: High grade glass fibre reinforced plastic

Discharge Rating

The table below shows the discharge rate in m³/h of the pressure relief valve at the specified pressure settings (in bar).

Pressure Setting-(bar)	1.5	2.0	2.5	3.0
Discharge Rating-(m ³ /h)	2.8	3.0	9.5	14.3

Dimensions

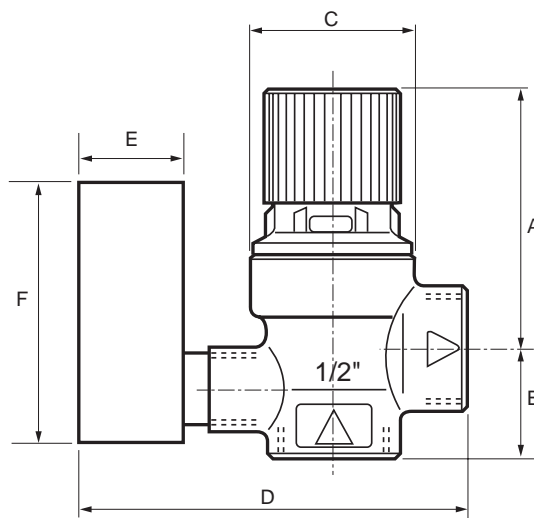

A	B	C	D	E	F
48.5	20.5	31	82	26	50

All dimensions in mm unless otherwise stated

Specifications

Set Pressure: 3.0 bar
Operating Temperature: 140°C Max.
Test Pressure of Body: 25 bar
Gauge: 0-4 bar

How to Specify

Pressure Relief Valve at pre-determined set opening pressure which is supplied with 1/2" FBSP inlet and outlet and integral pressure gauge. (Include correct product range code).

Guarantee

All Reliance® products undergo strict performance tests prior to despatch, and are guaranteed against faulty materials and workmanship for one year from date of purchase. This is in addition to any statutory rights.

Contacts:	Sales Enquiries	Technical Support
Telephone:	+44 (0)1386 712400	+44 (0)1386 47148
Fax:	+44 (0)1386 47028	+44 (0)1386 422217
E-Mail:	sales@rwc.co.uk	technical@rwc.co.uk



Reliance Water Controls®
Worcester Road, Evesham, Worcestershire, WR11 4RA, UK
Tel: +44 (0)1386 47148 Fax: +44 (0)1386 47028 www.rwc.co.uk

